

ecotile PVC-U skirting boards - The perfect way to finish your interlock floor tile installation

ecotile PVC-U skirting boards are the ultimate no hassle, no maintenance, easy fit and cost effective way to add the essential finishing touch to your ecotile installation. ecotile means no more time-consuming sanding and messy painting of timber skirting boards or architraves, and no more tricky mitring of corner joints.

Reduce fitting times by up to 50%, No more sanding and painting

Lengths of ecotile board simply slot together, with pre-moulded corner pieces to minimise the need for mitring. With ecotile you can fit perfectly square, attractive skirting boards and architraves in up to half the time it would take to install and paint conventional timber products. For homeowners, sanding and painting skirting boards and architraves is one of the most time-consuming, awkward and least-rewarding jobs involved in any decorating project. With PVC-U ecotile, it's a job you'll never have to do again. What's more, the wipe-clean surface means your room trims will stay looking clean and fresh for life.

Maintenance-free: PVC-U is maintenance-free. Any scuffs can simply be wiped off

Colour options: ecotile is available in Dark Grey, White, English Oak, and Rosewood finishes.

Sizes available: Skirting board: 100mm high x 15mm deep x 5m long or 100mm high x 15mm deep x 2.5m long

Accessories: Internal Corner Section, External Corner Section, Skirting in-line joint moulding section.

Ecotile LLP
434 – 436 Mutton Lane,
Potters Bar, Hertfordshire, EN6 3AT
Email: info@eco-tile.net
Tel: +44 (0) 1707 800 060
Fax: +44 (0) 2089 299 150
www.eco-tile.net



Product Range & Prices		
40.722 - 100mm Skirting x 2.5m (Dark Grey ONLY)	£9.99 per length	
40.723 - 100mm Skirting x 5m (White, Oak & Rosewood)	£19.50 per length	
40.724 - Skirting Internal Corner Trims (all colours)	£8.49 each	
40.725 - Skirting External Corner Trims (all colours)	£4.99 each	
40.726 - Skirting In-Line Joint Mouldings (Pack of 10)	£16.22 per kit	
77.500 – Webfix Adhesive (1 tube per 10m)	£5.99 per tube	

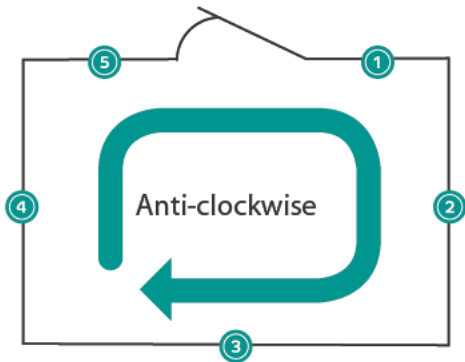

Always fit
ecotile skirting
boards from the
door opening in
an anti-clockwise
direction



1.1

Measure length 1 from the external edge of the architrave to the inside corner of the room. Transfer this measurement onto a length of skirting board and mark accurately with a pencil. Cut the skirting board to length using square cuts with the aid of a fine toothed saw and saw block. Position the skirting board to check length.

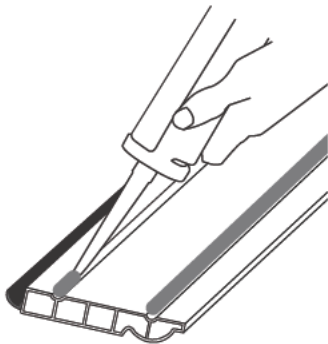

1.2

Lay the skirting board on its face and apply a bead of gap filling adhesive or another contact building adhesive down each adhesive channel. Place the skirting board in position pushing firmly back to the wall.

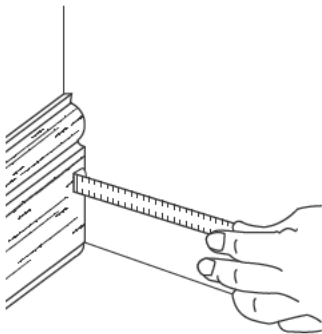

1.3

Measure length 2 from the flat face of the skirting board to the inside corner of the room. Cut to length using square cuts.



1.4

Apply contact adhesive to the scribed internal corner moulding (available from most DIY retailers).

Push onto the left hand end of the cut skirting board. Offer up and position the skirting board to check for length and trim if necessary. Once satisfied repeat stage 2.

1.5

Repeat this process until the room is complete.

External corners

Available separately from ecotile

PTO >>

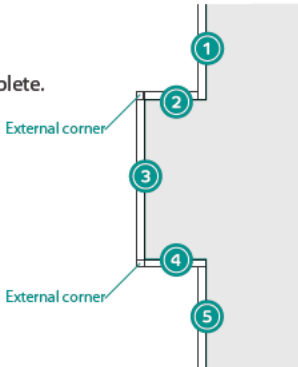



2.1

Measure from the flat face of skirting board 1 to the external corner of the wall. Cut the skirting board using square cuts. Fit a scribed internal corner moulding to the left hand end and check for fit. If satisfied fix in position with adhesive.

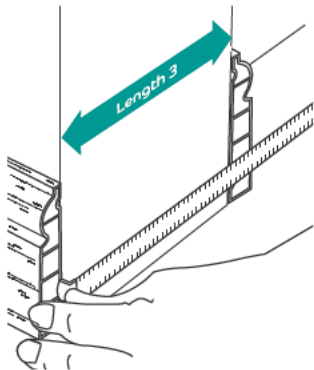

2.2

Measure length 4 from the inside corner of the room to the external corner of the room. Cut to length using square cuts. If satisfied with fit fix to wall using adhesive.

2.3

Measure length 3 from the inside faces of fitted lengths 2 & 4 and square cut to length.



2.4

Apply adhesive to the external corner mouldings and push fit onto each end of length 3. Apply adhesive to the back face of the skirting board and the remaining tabs of the corner mouldings and fix into position making sure that the tabs locate into their correct position within the previously fitted lengths 2 & 4. Wipe off any surplus adhesive.

3 - In-line joints

In-line joints can be created using the in-line joint moulding (available separately from your ecotile).

3.1

Cut the required lengths of skirting board to be jointed with accurate square cuts. Apply adhesive into the correct cavity of one cut length.

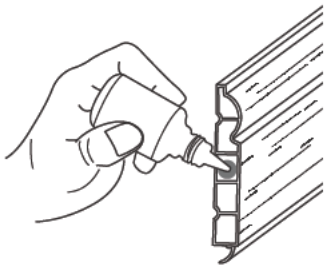

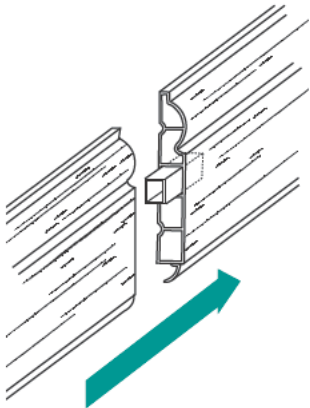

3.2

Push fit the in-line joint moulding so that half the moulding is inside the skirting and half protrudes.

3.3

Apply adhesive into the other length to be jointed and push fit onto the moulding until a tight fit is achieved. Wipe off any excess adhesive. Once jointed the length can be fitted in the conventional manner.